



£1,300
Walsworth Road
Hitchin, SG4 9FG

PROPERTY SUMMARY

Nestled on Walsworth Road in the charming town of Hitchin, this delightful ground floor apartment offers a perfect blend of comfort and convenience. Built in 2006, the property spans an impressive 710 square feet and features a well-designed layout that is ideal for modern living.

This property offers two parking bays with secured gates directly outside the apartment for use during tenancy.

Upon entering, you are welcomed into a spacious open plan living area that seamlessly connects to the kitchen, creating an inviting space for both relaxation and entertaining. The kitchen is generously sized and boasts ample storage, making it a practical choice for culinary enthusiasts.

The apartment comprises two double bedrooms, providing plenty of room for rest and privacy. The main bedroom is particularly noteworthy, as it comes equipped with fitted wardrobes, ensuring that storage is never an issue.

One of the standout features of this property is its prime location, situated conveniently next to Hitchin's train station. This makes commuting a breeze, whether for work or leisure.

2



1



1





PUTTERILLS
LETTINGS

est. 1992



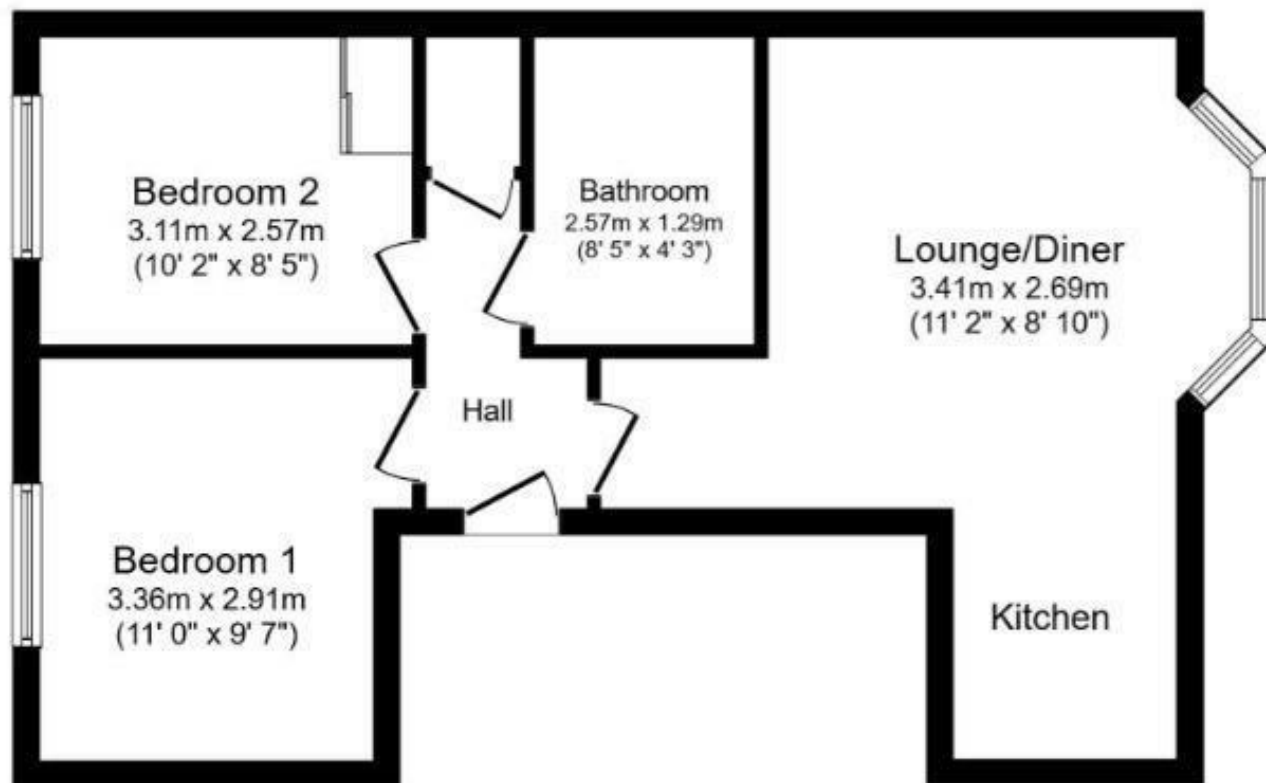

Ground Floor Plan

LOCAL AUTHORITY

TENURE

COUNCIL TAX BAND

C

VIEWINGS

By prior appointment only

Energy Efficiency Rating		
	Current	Potential
Very energy efficient - lower running costs		
(92 plus) A		
(81-91) B		
(69-80) C		
(55-68) D		
(39-54) E		
(21-38) F		
(1-20) G		
Not energy efficient - higher running costs		
England & Wales EU Directive 2002/91/EC		

Agents Note: Whilst every care has been taken to prepare these particulars, they are for guidance purposes only. All measurements are approximate and are for general guidance purposes only and whilst every care has been taken to ensure their accuracy, they should not be relied upon and potential buyers/tenants are advised to recheck the measurements



OFFICE ADDRESS

Hill House 1 St Albans Road
Codicote
SG4 8UT

OFFICE DETAILS

01462 419333
lettings@putterills.co.uk
www.putterills.co.uk